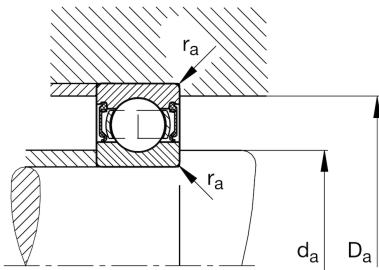
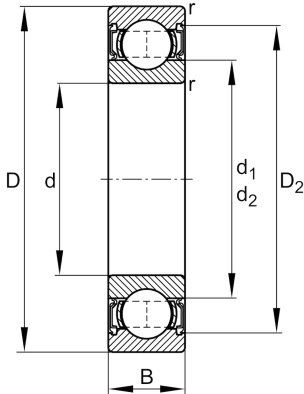

**FAG****6003-2RSR**

Deep groove ball bearing

Deep groove ball bearing 60...-2RSR, single row, seals, steel sheet metal cage

## Technical information

**Main Dimensions & Performance Data**

d	17 mm	Bore diameter
D	35 mm	Outside diameter
B	10 mm	Width
$C_r$	6,400 N	Basic dynamic load rating, radial
$C_{0r}$	3,250 N	Basic static load rating, radial
$C_{ur}$	162 N	Fatigue load limit, radial
$n_G$	11,800 1/min	Limiting speed
$\approx m$	39.5 g	Weight

**Mounting dimensions**

$d_{a \min}$	19 mm	Minimum diameter shaft shoulder
$D_{a \max}$	33 mm	Maximum diameter of housing shoulder
$r_{a \max}$	0.3 mm	Maximum fillet radius

**Dimensions**

$r_{\min}$	0.3 mm	Minimum chamfer dimension
$D_1$	29.51 mm	Shoulder diameter outer ring
$D_2$	30.81 mm	Caliber diameter outer ring
$d_1$	22.65 mm	Shoulder diameter inner ring

**Temperature range**

$T_{\min}$	-20 °C	Operating temperature min.
$T_{\max}$	100 °C	Operating temperature max.

**Calculation factors**

$f_0$	14.3	Calculation factor
-------	------	--------------------